

## A/23 Piezo Electric Accelerometer

8pC/g nom.

4/5gm wt.

250°C Max



A generic range of lightweight, Konic sensing element based vibration transducers offering a choice of integral stud or flat based adhesive attachment and each with side or top mounted connector. All welded construction maximizes temperature range, reliability and sensitivity is approximately double that of competitive mass products. Adhesive mounted versions: Abrasive cleaning of the attachment face will reduce base thickness over time; sparing use of adhesive will aid longevity.

A/23/E

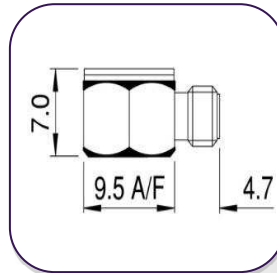

A/23/S

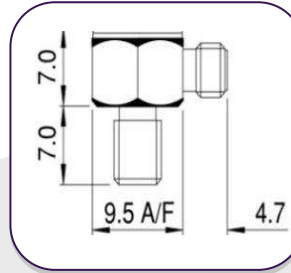

A/23/TS

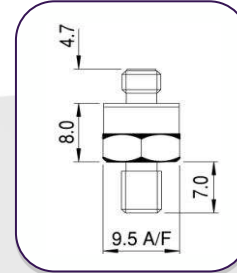

A/23/TE

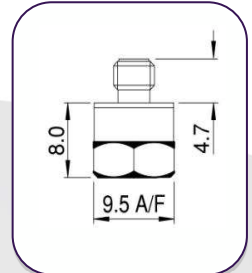

### Applications

- Model analysis, high level vibration to 5000g, and shock to 10,000g.
- high level measurements, top entry connector versions, minimising case loading, are preferred.

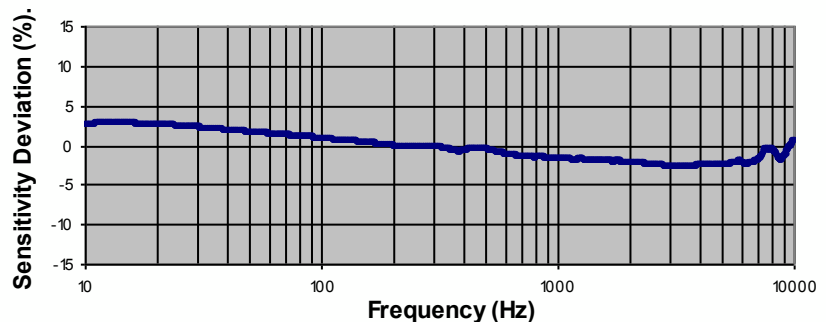

Typical Frequency Response

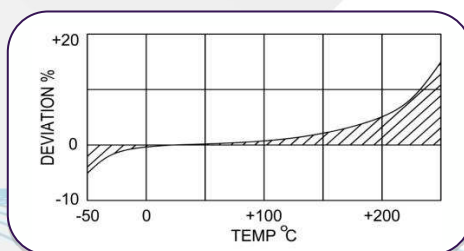

Temperature Response

### Options

- Close tolerance output
- Wideband temperature calibration
- Proof shock testing

Conversion Mode	Konic
Charge sensitivity pC/g nom.	6-11
Capacitance	800/1300
Resonant Frequency KHz	50
Cross Axis error % max	5
Temperature Range °C	-50/ +250
Charge sensitivity deviation re 20 °C	-5% @ -50 °C +15% @ +250 °C
Frequency Range	1Hz – 10KHz, +/- 5%
Maximum 'g level	5000
Maximum Shock g level	10000
Case Material	Titanium Grade 2
Connector	Microdot skt., 10/32 UNF thd.
Weight gm	4

**CMV Steck GmbH**

Rheinstraße 92

Tel: + 49 (0) 7275 988 684 - 0

www.CMV-Steck.de

D-76870 Kandel

Fax: + 49 (0) 7275 988 684 - 9

e-mail: info@CMV-Steck.de